

**CYCLAMEN EUROPAEUM- cyclamen purpurascens tuber pellet**

**Boiron**

*Disclaimer: This homeopathic product has not been evaluated by the Food and Drug Administration for safety or efficacy. FDA is not aware of scientific evidence to support homeopathy as effective.*

-----  
**Cyclamen europaeum 15C**

Cyclamen europaeum 15C

(\*\*contains 0.443 mg of the active ingredient per pellet)

Headaches or dizziness\*

Stop use and ask a doctor if symptoms persist for more than 3 days or worsen

If pregnant or breast-feeding ask a health professional before use

Keep out of reach of children

Do not use if pellet dispenser seal is broken.

Contains approx 80 pellets.

How to dispense pellets? Turn tube upside down. Twist until 5 pellets are dispensed into cap. Carefully remove the cap and use it to pour pellets under the tongue.

\*CLAIMS BASED ON TRADITIONAL HOMEOPATHIC PRACTICE NOT ACCEPTED MEDICAL EVIDENCE. NOT FDA EVALUATED.

\*C,K,CK, and X are homeopathic dilutions: see [BoironUSA.com/info](http://BoironUSA.com/info) for details.

lactose, sucrose

Adults and children: At the onset of symptoms, dissolve 5 pellets under the tongue 3 times a day until symptoms are relieved or as directed by a doctor.

1-800-BOIRON-1 (1-800-264-7661),

[BoironUSA.com](http://BoironUSA.com) [Info@boiron.com](mailto:Info@boiron.com)

Distributed by Boiron, Inc. Newtown Square, PA 19073

**Cyclamen europaeum** **15<sup>c</sup>**

HPUS NDC 0220-1643-41

**BOIRON®**  
HOMEOPATHIC MEDICINE Made in France

Headaches or dizziness.\*

Cyclamen europaeum

\*CLAIMS BASED ON TRADITIONAL HOMEOPATHIC PRACTICE NOT ACCEPTED MEDICAL EVIDENCE. NOT FDA EVALUATED.



Lot:

Exp:

n 15 c

3

06960

25912

1

Contains approx. 80 pellets.

US

Peel for Drugs Facts and instructions for use.

HEOPATHIC PRACTICE,  
NOT FDA EVALUATED.

## Drug Facts

**Active ingredient\*\***: See product name on front panel (contains 0.443 mg of the active ingredient per pellet).

**Uses**: See symptoms on front panel.

**Warnings**: Stop use and ask a doctor if symptoms persist for more than 3 days or worsen. If pregnant or breastfeeding, ask a health professional before use. Keep out of reach of children.

**Directions**: ■ Adults and children: At the onset of symptoms, dissolve 5 pellets under the tongue 3 times a day until symptoms are relieved or as directed by a doctor.

**Other information**: ■ Do not use if pellet dispenser seal is broken.

## Drug Facts (continued)

**Inactive ingredients**: lactose, sucrose

## Questions or comments?

BoironUSA.com Info@Boiron.com  
1-800-BOIRON-1 (1-800-264-7661)

**\*\*C, K, CK, and X are homeopathic dilutions: see BoironUSA.com/info for details.**

**Distributed by Boiron Inc.  
Newtown Square, PA 19073**

**How to dispense pellets?**



**1**  
Turn tube upside down.



**2**  
Twist until 5 pellets are dispensed into cap.

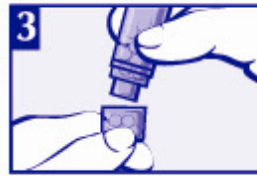

**3**  
Carefully remove cap and use it to pour pellets under the tongue.

## CYCLAMEN EUROPAEUM

cyclamen purpurascens tuber pellet

### Product Information

<b>Product Type</b>	HUMAN OTC DRUG	<b>Item Code (Source)</b>	NDC:0220-1643
<b>Route of Administration</b>	ORAL		

### Active Ingredient/Active Moiety

Ingredient Name	Basis of Strength	Strength
CYCLAMEN PURPURASCENS TUBER (UNII: G728 143D8 Q) (CYCLAMEN PURPURASCENS TUBER - UNII:G728 143D8 Q)	CYCLAMEN PURPURASCENS TUBER	15 [hp_C] in 15 [hp_C]

### Inactive Ingredients

Ingredient Name	Strength
LACTOSE, UNSPECIFIED FORM (UNII: J2B2A4N98 G)	
SUCROSE (UNII: C151H8M554)	

### Product Characteristics

<b>Color</b>	white	<b>Score</b>	
<b>Shape</b>	ROUND	<b>Size</b>	4mm
<b>Flavor</b>		<b>Imprint Code</b>	
<b>Contains</b>			

**Packaging**

#	Item Code	Package Description	Marketing Start Date	Marketing End Date
1	NDC:0220-1643-41	15 [hp_C] in 1 TUBE; Type 0: Not a Combination Product	03/03/1983	

**Marketing Information**

Marketing Category	Application Number or Monograph Citation	Marketing Start Date	Marketing End Date
unapproved homeopathic		03/03/1983	

**Labeler** - Boiron (282560473)**Registrant** - Boiron, Inc. (014892269)**Establishment**

Name	Address	ID/FEI	Business Operations
Boiron		282560473	manufacture(0220-1643)

Revised: 4/2019

Boiron