

**TRILLIUM PENDULUM- trillium erectum root pellet**  
**Boiron**

*Disclaimer: This homeopathic product has not been evaluated by the Food and Drug Administration for safety or efficacy. FDA is not aware of scientific evidence to support homeopathy as effective.*

-----  
**Trillium pendulum 9C**

Trillium pendulum 9C

(\*\*contains 0.443 mg of the active ingredient per pellet)

Heavy menstruation with fatigue\*

Stop use and ask a doctor if symptoms persist for more than 3 days or worsen

If pregnant or breast-feeding ask a health professional before use

Keep out of reach of children

Do not use if pellet dispenser seal is broken.

Contains approx 80 pellets.

How to dispense pellets? Turn tube upside down. Twist until 5 pellets are dispensed into cap. Carefully remove the cap and use it to pour pellets under the tongue.

\*CLAIMS BASED ON TRADITIONAL HOMEOPATHIC PRACTICE NOT ACCEPTED MEDICAL EVIDENCE. NOT FDA EVALUATED.

\*C,K,CK, and X are homeopathic dilutions: see BoironUSA.com/info for details.

lactose, sucrose

Adults and children: At the onset of symptoms, dissolve 5 pellets under the tongue 3 times a day until symptoms are relieved or as directed by a doctor.

1-800-BOIRON-1 (1-800-264-7661),

BoironUSA.com Info@boiron.com

Distributed by Boiron, Inc. Newtown Square, PA 19073

**Trillium pendulum** 9<sup>c</sup>

HPUS NDC 0220-5049-41

**BOIRON**<sup>®</sup>  
HOMEOPATHIC MEDICINE Made in France

Trillium pendulum

Heavy menstruation with fatigue.\*

\*CLAIMS BASED ON TRADITIONAL HOMEOPATHIC PRACTICE NOT ACCEPTED MEDICAL EVIDENCE. NOT FDA EVALUATED.



Lot:

Exp:

9 c

3

06960

75010

9

Contains approx. 80 pellets.

US

Peel for Drugs Facts and instructions for use.

HEOPATHIC PRACTICE,  
NOT FDA EVALUATED.

## Drug Facts

**Active ingredient\*\***: See product name on front panel (contains 0.443 mg of the active ingredient per pellet).

**Uses**: See symptoms on front panel.

**Warnings**: Stop use and ask a doctor if symptoms persist for more than 3 days or worsen. If pregnant or breastfeeding, ask a health professional before use. Keep out of reach of children.

**Directions**: ■ Adults and children: At the onset of symptoms, dissolve 5 pellets under the tongue 3 times a day until symptoms are relieved or as directed by a doctor.

**Other information**: ■ Do not use if pellet dispenser seal is broken.

## Drug Facts (continued)

**Inactive ingredients**: lactose, sucrose

## Questions or comments?

BoironUSA.com Info@Boiron.com  
1-800-BOIRON-1 (1-800-264-7661)

**\*\*C, K, CK, and X are homeopathic dilutions: see BoironUSA.com/info for details.**

**Distributed by Boiron Inc.  
Newtown Square, PA 19073**

**How to dispense pellets?**



**1**  
Turn tube upside down.



**2**  
Twist until 5 pellets are dispensed into cap.

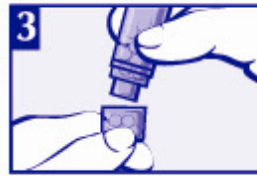

**3**  
Carefully remove cap and use it to pour pellets under the tongue.

## TRILLIUM PENDULUM

trillium erectum root pellet

### Product Information

<b>Product Type</b>	HUMAN OTC DRUG	<b>Item Code (Source)</b>	NDC:0220-5049
<b>Route of Administration</b>	ORAL		

### Active Ingredient/Active Moiety

Ingredient Name	Basis of Strength	Strength
TRILLIUM ERECTUM ROOT (UNII: AHW6F0T2X0) (TRILLIUM ERECTUM ROOT - UNII:AWH6F0T2X0)	TRILLIUM ERECTUM ROOT	9 [hp_C] in 9 [hp_C]

### Inactive Ingredients

Ingredient Name	Strength
SUCROSE (UNII: C151H8M554)	
LACTOSE, UNSPECIFIED FORM (UNII: J2B2A4N98G)	

### Product Characteristics

<b>Color</b>	white	<b>Score</b>	
<b>Shape</b>	ROUND	<b>Size</b>	4mm
<b>Flavor</b>		<b>Imprint Code</b>	
<b>Contains</b>			

**Packaging**

#	Item Code	Package Description	Marketing Start Date	Marketing End Date
1	NDC:0220-5049-41	9 [hp_C] in 1 TUBE; Type 0: Not a Combination Product	03/03/1983	

**Marketing Information**

Marketing Category	Application Number or Monograph Citation	Marketing Start Date	Marketing End Date
unapproved homeopathic		03/03/1983	

**Labeler** - Boiron (282560473)**Registrant** - Boiron, Inc. (014892269)**Establishment**

Name	Address	ID/FEI	Business Operations
Boiron		282560473	manufacture(0220-5049)

Revised: 4/2019

Boiron